

Deseen International

Cast iron valve



目录 CONTENTS

铸铁暗杆闸阀 ANSI-125/150 CAST IRON GATE VALVE(NON RISING STEM)	01
铸铁明杆闸阀 ANSI-125/150 CAST IRON GATE VALVE(RISING STEM)	01
铸铁旋启式止回阀 ANSI-125/150 CAST IRON SWING CHECK VALVE	02
铸铁Y型过滤器 ANSI-125/150 CAST IRON Y-STRAINER	02
铸铁截止阀 ANSI-125/150 CAST IRON GLOBE VALVE	03
铸铁球阀 ANSI-125/150 CAST IRON BALL VALVE	03
铸铁暗杆闸阀 DIN 3352-F4 CAST IRON GATE VALVE(NON RISING STEM)	04
铸铁暗杆闸阀 JIS-10K CAST IRON GATE VALVE(NON RISING STEM)	04
铸铁明杆闸阀 JIS-10K/16K CAST IRON GATE VALVE (RISING STEM)	05
铸铁旋启式止回阀 JIS-10K/16K CAST IRON SWING CHECK VALVE	05
铸铁Y型过滤器 JIS-10K/16K CAST IRON Y-STRAINER	06
铸铁截止阀 JIS-10K/16K CAST IRON GLOBE VALVE	06
铸铁球阀 JIS-10K/16K CAST IRON BALL VALVE	07
铸铁旋启式止回阀 JIS-10K CAST IRON SWING CHECK VALVE	07
丝口闸阀 Z15T/Z15W CAST IRON GATE VALVE (NON-RISING STEM)	08
铸铁船用截止阀 JIS-F7306/F7308 CAST IRON ANGLE GLOBE VALVE	08
法兰规格表	09

Deseen International

Cast iron valve

铸铁暗杆闸阀 ANSI-125/150 CAST IRON GATE VALVE(NON RISING STEM)

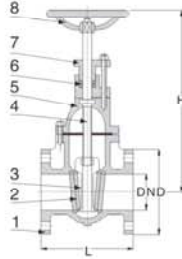

Application

1	Face to face is according to ANSI B16.10
2	Flange drilled is according to ANSI B16.1

Test

Working pressure	125PSI	150PSI
Test pressure Shell	21.1kgf/cm ²	
Seat	15.0kgf/cm ²	

Components

1	Body	Cast iron or ductile iron
2	Seating	Cast bronze / stainless steel (B62/SS304)
3	Disc	Cast iron or ductile iron
4	Stem	Stainless steel
5	Bonnet	Cast iron or ductile iron
6	Packing	Not asbestos
7	Gland	Ductile iron
8	Handwheel	Cast iron or ductile iron

Dimensions

DN	40	50	65	80	100	125	150	200	250	300	350	400	450	500
	1.5"	2"	2.5"	3"	4"	5"	6"	8"	10"	12"	14"	16"	18"	20"
L	165	178	190	203	230	254	267	292	330	356	381	406	432	457
H	245	255	275	295	370	425	460	580	495	785	966	1380	1656	1987
D	127	152	178	191	229	254	279	343	406	483	533	597	635	699

铸铁明杆闸阀 ANSI-125/150 CAST IRON GATE VALVE(RISING STEM)

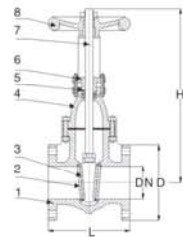

Application

1	Face to face is according to ANSI B16.10
2	Flange drilled is according to ANSI B16.1

Test

Working pressure	125PSI	150PSI
Test pressure Shell	21.1kgf/cm ²	
Seat	15.0kgf/cm ²	

Components

1	Body	Cast iron or Ductile iron
2	Seating	Cast bronze or stainless steel
3	Disc	Cast iron or Ductile iron
4	Bonnet	Cast iron or Ductile iron
5	Packing	Not asbestos
6	Gland	Ductile iron
7	Stem	Stainless steel
8	Handwheel	Cast iron or Ductile iron

Dimensions

DN	40	50	65	80	100	125	150	200	250	300	350	400	450	500
	1.5"	2"	2.5"	3"	4"	5"	6"	8"	10"	12"	14"	16"	18"	20"
L	165	178	190	203	230	254	267	292	330	356	381	406	432	457
H	254	267	279	305	406	457	559	711	889	1117	1560	1780	1950	2110
D	127	152	178	191	229	254	279	343	406	483	533	597	635	699

01

铸铁旋启式止回阀 ANSI-125/150 CAST IRON SWING CHECK VALVE

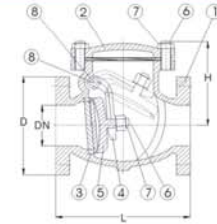

Application

1	Face to face is according to ANSI B16.10
2	Flange drilled is according to ANSI B16.1

Test		
Working pressure	125PSI	150PSI
Test pressure Shell	21.1kgf/cm ²	
Seat	15.4kgf/cm ²	

Components

No.	Parts	Material
1	Body	Cast iron or Ductile iron
2	Bonnet	Cast iron or Ductile iron
3	Seating	Cast bronze/Stainless steel (BC6/SS304)
4	Arm	Cast iron or Ductile iron
5	Disc	Cast iron or Ductile iron
6	Bolt	Carbon steel
7	Nut	Carbon steel
8	Pin	Stainless steel
8	Drain plug	Stainless steel

Dimensions

DN	40	50	65	80	100	125	150	200	250	300	400
	1.5	2	2.5	3	4	5	6	8	10	12	16
L	165	203	216	241	292	330	356	495	622	698	914
H	101	102	114	139	152	170	203	246	292	330	405
D	127	152	178	191	229	254	279	343	406	483	597

铸铁Y型过滤器 ANSI-125/150 CAST IRON Y-STRAINER

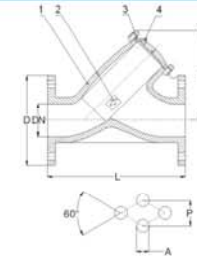

Application

1	Face to face is according to ANSI 125/150
2	Flange drilled is according to ANSI B16.1

Test		
Working pressure	125PSI	150PSI
Test pressure Shell	21.1kgf/cm ²	

Screen dimensions			
DN	A	P	Thickness
5" or smaller	φ 1.5	2.5	0.5
6" & 8"	φ 3.0	5.0	1.0
10" & larger	φ 5.0	7.0	1.0

Components		
1	Body	Cast iron or Ductile iron
2	Bonnet	Cast iron or Ductile iron
3	Screen	Stainless steel
4	Drain plug	Carbon steel

Dimensions

DN	50	65	80	100	125	150	200	250	300
	2"	2.5"	3"	4"	5"	6"	8"	10"	12"
L	250	285	315	370	420	490	570	620	800
H	170	200	245	280	320	365	465	515	605
D	152	178	191	229	254	279	343	406	483

02

Deseen International

Cast iron valve

铸铁暗杆闸阀 ANSI-125/150 CAST IRON GATE VALVE(NON RISING STEM)

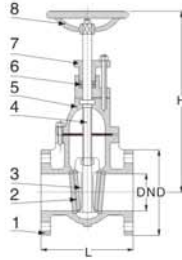

Application

1	Face to face is according to ANSI B16.10
2	Flange drilled is according to ANSI B16.1

Test

Working pressure	125PSI	150PSI
Test pressure Shell	21.1kgf/cm ²	
Seat	15.0kgf/cm ²	

Dimensions

DN	40	50	65	80	100	125	150	200	250	300	350	400	450	500
	1.5"	2"	2.5"	3"	4"	5"	6"	8"	10"	12"	14"	16"	18"	20"
L	165	178	190	203	230	254	267	292	330	356	381	406	432	457
H	245	255	275	295	370	425	460	580	495	785	966	1380	1656	1987
D	127	152	178	191	229	254	279	343	406	483	533	597	635	699

Components

1	Body	Cast iron or ductile iron
2	Seating	Cast bronze / stainless steel (B62/SS304)
3	Disc	Cast iron or ductile iron
4	Stem	Stainless steel
5	Bonnet	Cast iron or ductile iron
6	Packing	Not asbestos
7	Gland	Ductile iron
8	Handwheel	Cast iron or ductile iron

铸铁明杆闸阀 ANSI-125/150 CAST IRON GATE VALVE(RISING STEM)

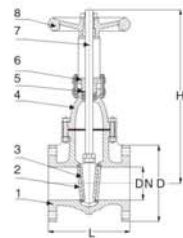

Application

1	Face to face is according to ANSI B16.10
2	Flange drilled is according to ANSI B16.1

Test

Working pressure	125PSI	150PSI
Test pressure Shell	21.1kgf/cm ²	
Seat	15.0kgf/cm ²	

Dimensions

DN	40	50	65	80	100	125	150	200	250	300	350	400	450	500
	1.5"	2"	2.5"	3"	4"	5"	6"	8"	10"	12"	14"	16"	18"	20"
L	165	178	190	203	230	254	267	292	330	356	381	406	432	457
H	254	267	279	305	406	457	559	711	889	1117	1560	1780	1950	2110
D	127	152	178	191	229	254	279	343	406	483	533	597	635	699

01

铸铁旋启式止回阀 ANSI-125/150 CAST IRON SWING CHECK VALVE

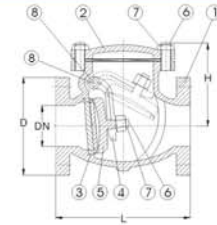

Application

1	Face to face is according to ANSI B16.10
2	Flange drilled is according to ANSI B16.1

Test

Working pressure	125PSI	150PSI
Test pressure Shell	21.1kgf/cm ²	
Seat	15.4kgf/cm ²	

Dimensions

DN	40	50	65	80	100	125	150	200	250	300	400
	1.5"	2"	2.5"	3"	4"	5"	6"	8"	10"	12"	16"
L	165	203	216	241	292	330	356	495	622	698	914
H	101	102	114	139	152	170	203	246	292	330	405
D	127	152	178	191	229	254	279	343	406	483	597

Components

No.	Parts	Material
1	Body	Cast iron or Ductile iron
2	Bonnet	Cast iron or Ductile iron
3	Seating	Cast bronze/Stainless steel (BC6/SS304)
4	Arm	Cast iron or Ductile iron
5	Disc	Cast iron or Ductile iron
6	Bolt	Carbon steel
7	Nut	Carbon steel
8	Pin	Stainless steel
8	Drain plug	Stainless steel

铸铁Y型过滤器 ANSI-125/150 CAST IRON Y-STRAINER

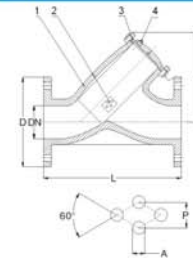

Application

1	Face to face is according to ANSI 125/150
2	Flange drilled is according to ANSI B16.1

Test

Working pressure	125PSI	150PSI
Test pressure Shell	21.1kgf/cm ²	

Dimensions

DN	50	65	80	100	125	150	200	250	300
	2"	2.5"	3"	4"	5"	6"	8"	10"	12"
L	250	285	315	370	420	490	570	620	800
H	170	200	245	280	320	365	465	515	605
D	152	178	191	229	254	279	343	406	483

Screen dimensions			
DN	A	P	Thickness
5" or smaller	φ 1.5	2.5	0.5
6" & 8"	φ 3.0	5.0	1.0
10" & larger	φ 5.0	7.0	1.0

Components		
1	Body	Cast iron or Ductile iron
2	Bonnet	Cast iron or Ductile iron
3	Screen	Stainless steel
4	Drain plug	Carbon steel

02

Deseen International

Cast iron valve

铸铁截止阀 ANSI-125/150 CAST IRON GLOBE VALVE

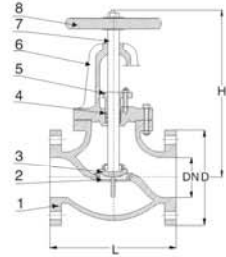

Application

1	Face to face is according to ANSI B16.10
2	Flange drilled is according to ANSI B16.1

Test

Working pressure	125PSI	150PSI
Test pressure Shell	21.1kgf/cm ²	
Seat	15.0kgf/cm ²	

Dimensions

DN	40	50	65	80	100	125	150	200	250	300
	1.5"	2"	2.5"	3"	4"	5"	6"	8"	10"	12"
L	165	203	216	241	292	330	356	495	622	698
H	254	266	279	304	405	450	550	710	880	1000
D	127	152	178	191	229	254	279	343	406	483

Components

1	Body	Cast iron or Ductile iron
2	Seating	Cast bronze/Stainless steel (BC6/SS304)
3	Disc	Ductile iron with B62/SS304
4	Packing	Not asbestos
5	Gland	Ductile iron
6	Bonnet	Cast iron or Ductile iron
7	Stem	Stainless steel
8	Handwheel	Cast iron or Ductile iron

铸铁球阀 ANSI-125/150 CAST IRON BALL VALVE

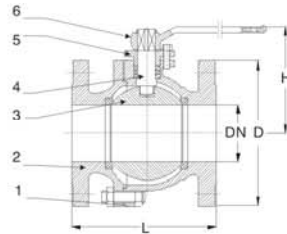

Application

1	Face to face is according to ANSI B16.10
2	Flange drilled is according to ANSI B16.1

Test

Working pressure	125PSI	150PSI
Test pressure Shell	21.1kgf/cm ²	
Seat	15.0kgf/cm ²	

Dimensions

DN	15	20	25	32	40	50	65	80	100	125	150	200	250
	1/2"	3/4"	1"	1.25"	1.5"	2"	2.5"	3"	4"	5"	6"	8"	10"
L	108	117	127	140	165	178	190	203	229	356	394	457	533
H	59	63	75	86	97	131	142	170	201	252	286	340	410
D	89	98	108	117	127	152	178	191	229	254	279	343	406

03

铸铁暗杆闸阀 DIN 3352-F4 CAST IRON GATE VALVE(NON RISING STEM)

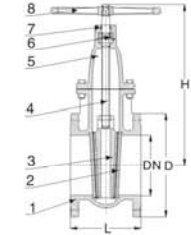

Application

1	Face to face is according to DIN 3302
2	Flange drilled is according to DIN 2532/2533

Test

Working pressure	PN10	PN16
Test pressure Shell	21.1kgf/cm ²	24kgf/cm ²
Seat	15kgf/cm ²	17.6kgf/cm ²

Dimensions

DN	40	50	65	80	100	125	150	200	250	300	350	400
	1.5"	2"	2.5"	3"	4"	5"	6"	8"	10"	12"	14"	16"
L	140	150	170	180	190	200	210	230	250	270	290	310
H	212	236	262	292	336	400	438	552	668	714	805	917
D(PN10)	150	165	185	200	220	250	285	340	395	445	505	565
D(PN16)	150	165	185	200	220	250	285	340	405	460	520	580

Components

No.	Parts	Material
1	Body	Cast iron or Ductile iron
2	Seat ring	Cast bronze/Stainless steel (BC6/SS304)
3	Disc	Cast iron or Ductile iron
4	stem	Stainless steel
5	Bonnet	Cast iron or Ductile iron
6	Packing	Not asbestos
7	Gland	Cast iron or Ductile iron
8	Handwheel	Cast iron or Ductile iron

铸铁暗杆闸阀 JIS-10K CAST IRON GATE VALVE(NON RISING STEM)

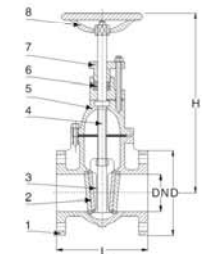

Application

1	Face to face is according to JIS B2002
2	Flange drilled is according to JIS B2212/2213

Test

Working pressure	10K	16K
Test pressure Shell	21.1kgf/cm ²	24kgf/cm ²
Seat	15.0kgf/cm ²	17.6kgf/cm ²

Dimensions

DN	40	50	65	80	100	125	150	200	250	300	350	400	450	500
	1.5"	2"	2.5"	3"	4"	5"	6"	8"	10"	12"	14"	16"	18"	20"
L	165	180	190	200	230	250	270	290	330	350	381	406	432	457
H	245	252	270	290	365	420	455	575	486	782	945	1350	1620	1945
D(10K)	140	155	175	185	210	250	280	330	400	445	490	560	620	675
D(16K)	140	155	175	200	225	270	305	350	430	480	540	605	675	730

Components

1	Body	Cast iron or Ductile iron
2	Seating	Cast bronze/Stainless steel (B62/SS304)
3	Disc	Cast iron or Ductile iron
4	Stem	Stainless steel
5	Bonnet	Cast iron or Ductile iron
6	Packing	Not asbestos
7	Gland	Ductile iron
8	Handwheel	Cast iron or Ductile iron

04

Deseen International

Cast iron valve

铸铁明杆闸阀 JIS-10K/16K CAST IRON GATE VALVE (RISING STEM)

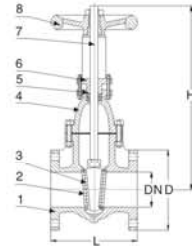

Application

1	Face to face is according to JIS B2002
2	Flange drilled is according to JIS B2212/2213

Test

Working pressure	10K	16K
Test pressure/Shell	21.1kgf/cm ²	24kgf/cm ²
Seat	15.0kgf/cm ²	17.6kgf/cm ²

Dimensions

DN	40	50	65	80	100	125	150	200	250	300	350	400	450	500
L	165	180	190	200	230	250	270	290	330	350	381	406	432	457
H	245	267	279	305	406	457	559	705	882	1110	1480	1735	1925	2005
D(10K)	140	155	175	185	210	250	280	330	400	445	490	500	620	675
D(16K)	140	155	175	200	225	270	305	350	430	480	540	650	675	730

Components

1	Body	Cast iron or Ductile iron
2	Seating	Cast bronze/Stainless steel (B62/SS304)
3	Disc	Cast iron or Ductile iron
4	Bonnet	Cast iron or Ductile iron
5	Packing	Not asbestos
6	Gland	Ductile iron
7	Stem	Stainless steel
8	Handwheel	Cast iron or Ductile iron

铸铁旋启式止回阀 JIS-10K/16K CAST IRON SWING CHECK VALVE

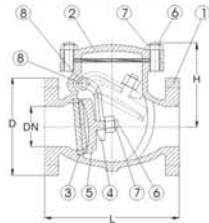

Application

1	Face to face is according to JIS B2002
2	Flange drilled is according to JIS B2212/2213

Test		
Working pressure	10K	16K
Test pressure/Shell	21.1kgf/cm ²	24kgf/cm ²
Seat	15.4kgf/cm ²	17.6kgf/cm ²

Dimensions

DN	40	50	65	80	100	125	150	200	250	300	400
L	165	203	216	241	292	356	410	495	622	698	914
H	100	105	115	140	155	170	203	246	283	330	395
D(10K)	140	155	175	185	210	250	280	330	400	445	560
D(16K)	140	155	175	200	225	270	305	350	430	480	605

Components

No.	Parts	Material
1	Body	Cast iron or Ductile iron
2	Bonnet	Cast iron or Ductile iron
3	Seating	Cast bronze/Stainless steel (BC6/SS304)
4	Arm	Cast iron or Ductile iron
5	Disc	Cast iron or Ductile iron
6	Bolt	Carbon steel
7	Nut	Carbon steel
8	Pin	Stainless steel
8	Drain plug	Stainless steel

05

铸铁Y型过滤器 JIS-10K/16K CAST IRON Y-STRAINER

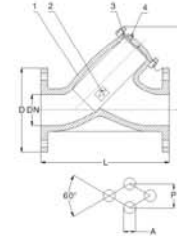

Application

1	Face to Face is according to JIS-10K
2	Flange drilled is according to JIS B2212/B2213

Test		
Working pressure	10K	16K
Test pressure/Shell	21.1kgf/cm ²	24kgf/cm ²

Dimensions

DN	50	65	80	100	125	150	200	250	300
L	250	285	315	370	420	490	570	680	800
H	168	185	200	255	295	345	425	515	600
D(10K)	155	175	185	210	250	280	330	400	445
D(16K)	155	175	200	225	270	305	350	430	480

Screen dimensions			
DN	A	P	Thickness
5" or smaller	φ 1.5	2.5	0.5
6" & 8"	φ 3.0	5.0	1.0
10" & larger	φ 5.0	7.0	1.0
Components			
1	Body	Cast iron or Ductile iron	
2	Bonnet	Cast iron or Ductile iron	
3	Screen	Stainless steel	
4	Drain plug	Carbon steel	

铸铁截止阀 JIS-10K/16K CAST IRON GLOBE VALVE

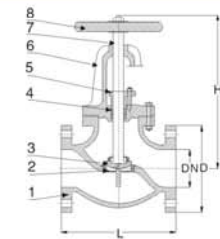

Application

1	Face to face is according to JIS B2002
2	Flange drilled is according to JIS B2212/2213

Test		
Working pressure	10K	16K
Test pressure/Shell	21.1kgf/cm ²	24kgf/cm ²
Seat	15.0kgf/cm ²	17.6kgf/cm ²

Dimensions

DN	40	50	65	80	100	125	150	200	250	300
L	165	203	216	241	292	356	410	495	622	698
H	254	266	279	304	405	450	550	710	880	1000
D(10K)	140	155	175	185	210	250	280	330	400	445
D(16K)	140	155	175	200	225	270	305	350	430	480

Components

1	Body	Cast iron or Ductile iron
2	Seating	Cast bronze/Stainless steel (B62/SS304)
3	Disc	Ductile iron with B62/SS304
4	Packing	Not asbestos
5	Gland	Ductile iron
6	Bonnet	Cast iron or Ductile iron
7	Stem	Stainless steel
8	Handwheel	Cast iron or Ductile iron

06

Deseen International

Cast iron valve

铸铁球阀 JIS-10K/16K CAST IRON BALL VALVE

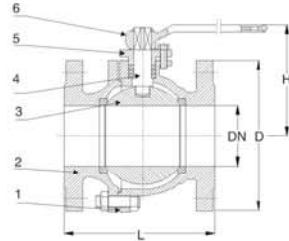

Application

1	Face to face is according to JIS B2002
2	Flange drilled is according to JIS B2212/B2213

Test

Working pressure	10K	16K
Test pressure Shell	21.1kgf/cm ²	35kgf/cm ²
Seat	15.0kgf/cm ²	25kgf/cm ²

Dimensions

DN	15	20	25	32	40	50	65	80	100	125	150	200	250
L	108	117	127	140	165	178	190	203	229	356	394	457	533
H	59	63	75	86	97	131	142	170	201	252	286	340	407
D(10K)	95	100	125	135	140	155	175	185	210	250	280	330	400
D(16K)	95	100	125	135	140	155	175	200	225	270	350	350	430

Components

No.	Parts	Material
1	Body	Cast iron or Ductile iron
2	Bonnet	Cast iron or Ductile iron
3	Ball	Stainless steel
4	stem	Stainless steel
5	Glandpacking	PTFE
6	Handle	Ductile iron

铸铁旋启式止回阀 JIS-10K CAST IRON SWING CHECK VALVE

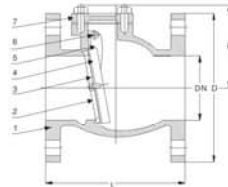

Application

1	Face to face is according to JIS 10K
2	Flange drilled is according to JIS B2212

Test		
Working pressure	10K	
Pressure Shell	15.1kgf/cm ²	
Seat	11.0kgf/cm ²	

Dimensions

DN	50	65	80	100	125	150	200	250
L	150	165	175	220	245	295	365	412
H	70	80	80	100	125	140	185	230
D	155	175	185	210	250	280	330	400

Components

No.	Parts	Material
1	Body	Cast iron or Ductile iron
2	Seating	Cast bronze (B62)
3	Disc	Cast iron or Ductile iron
4	Discseat	NBR
5	Arm	Cast iron or Ductile iron
6	Pin	Carbon steel
7	Bonnet	Cast iron or Ductile iron

07

丝口闸阀 Z15T/Z15W CAST IRON GATE VALVE (NON-RISING STEM)

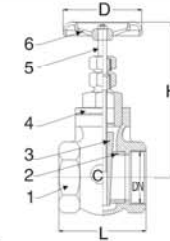

Test

Nominal pressure		Mpa	1.0
Test pressure	Pressure		1.5
	Seat		1.1
Suitable Temp			≤200
Suitable Media			W.O.G. etc

Dimensions

DN	5	20	25	32	40	50	65	80	100
L	65	70	80	90	100	110	130	135	160
H	113	115	135	150	180	205	240	240	300
D	63	63	70	70	85	105	120	120	140

Components

No.	PARTS	Z15T-10K	Z15W-10K
1	Body	CI	CI
2	Seal	Brass	Body
3	Disc	CI, Brass	CI, Brass
4	Bonnet	CI	CI
5	Stem	Brass	Brass
6	Handwheel	CI	CI

铸铁船用截止阀 JIS-F7306/F7308 CAST IRON ANGLE GLOBE VALVE

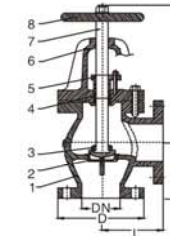

Application

1	Face to face is according to JIS-F7306/F7308
2	Flange drilled is according to JIS B2211/B2212

Test		
Working pressure	5K	10K
Test pressure Shell	10.5kgf/cm ²	21.1kgf/cm ²
Seat	7.7kgf/cm ²	15.4kgf/cm ²

Dimensions

DN	50	65	80	100	125	150	200	250	300
L	100	115	130	150	170	190	220	275	310
H	240	225	265	310	330	380	450	540	610
D(5K)	130	155	180	200	235	265	320	385	430
D(10K)	155	175	185	210	250	280	330	400	445

Components

No.	Parts	Material
1	Body	Cast iron(FC20)
2	Seating	Cast bronze/Stainless steel (B62/SS304)
3	Disc	Cast iron(FC20)
4	Packing	Not asbestos
5	Gland	Ductile iron(FCD45)
6	Bonnet	Cast iron(FC20)
7	Stem	Stainless steel(2Cr13)
8	Handwheel	Cast iron(FC20)

09

Deseen International Cast iron valve

法兰规格表

JIS 10kg/cm²型 FLANGES

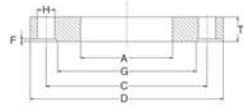

※尺寸	内径	※外径	厚	※厚度	※孔径	※中心	※孔径	※孔数
(B)	A	D	T	F	G	C	H	N
1+	50	140	16	2	85	105	19	4
2	61.5	155	16	2	100	120	19	4
2+	77.5	175	18	2	120	140	19	4
3	90	185	18	2	130	150	19	8
3+	103	195	18	2	140	160	19	8
4	116	210	18	2	155	175	19	8
5	142	250	20	2	185	210	23	8
6	167	280	22	2	215	240	23	8
8	218	330	22	2	265	290	23	12
10	270	400	24	2	325	355	25	12
12	320	445	24	3	370	400	25	16
14	358	490	26	3	415	445	25	16
16	409	560	28	3	475	510	27	16

JIS 16kg/cm²型 FLANGES

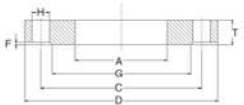

※尺寸	内径	※外径	厚	※厚度	※孔径	※中心	※孔径	※孔数
(B)	A	D	T	F	G	C	H	N
1+	50	140	16	2	85	105	19	4
2	61.5	155	16	2	100	120	19	8
2+	77.5	175	18	2	120	140	19	8
3	90	200	20	2	135	160	22	8
3+	103	210	20	2	145	170	22	8
4	116	225	22	2	160	185	22	8
5	142	270	22	2	195	225	25	8
6	167	305	24	2	230	260	25	12
8	218	350	26	2	275	305	25	12
10	270	430	28	2	345	360	29	12
12	320	480	30	3	395	430	29	16
14	358	540	34	3	440	480	32	16
16	409	605	38	3	495	540	35	16

JIS 20kg/cm²型 FLANGES

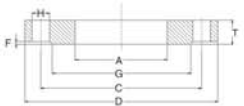

※尺寸	内径	※外径	厚	※厚度	※孔径	※中心	※孔径	※孔数
(B)	A	D	T	F	G	C	H	N
1+	50	140	16	2	85	105	19	4
2	61.5	155	18	2	100	120	19	8
2+	77.5	175	20	2	120	140	19	8
3	90	200	22	2	135	160	23	8
3+	103	210	24	2	145	170	23	8
4	116	225	24	2	160	185	23	8
5	142	270	26	2	195	225	25	8
6	167	305	28	2	230	260	25	12
8	218	350	30	2	275	305	25	12
10	270	430	34	2	345	360	27	12
12	320	480	36	3	395	430	27	16
14	358	540	40	3	440	480	33	16
16	409	605	46	3	495	540	33	16

ANSI 125型 FLANGES

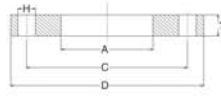

※尺寸	内径	※外径	厚	※厚度	※孔径	※中心	※孔径	※孔数
(B)	A	D	T	F	G	C	H	N
1+	50	127	14.3	1.6	73	98.5	16	4
2	61.5	152	15.9	1.6	92	120.5	19	4
2+	77.5	178	17.5	1.6	105	139.5	19	4
3	90	190	19.1	1.6	127	152.5	19	4
4	116	229	23.9	1.6	157	190.5	19	8
5	142	254	23.9	1.6	186	218.0	22	8
6	167	279	25.4	1.6	216	241.5	22	8
8	218	343	28.6	1.6	270	298.5	22	8
10	270	406	30.2	1.6	324	362.0	25	12
12	320	483	31.8	1.6	381	432.0	25	12
14	358	533	35.0	1.6	413	476.5	29	12
16	409	597	36.8	1.6	470	539.5	29	16

ANSI 150型 FLANGES

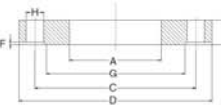

※尺寸	内径	※外径	厚	※厚度	※孔径	※中心	※孔径	※孔数
(B)	A	D	T	F	G	C	H	N
1+	50	127	17.5	1.6	73	98.5	16	4
2	61.5	152	19.1	1.6	92	120.5	19	4
2+	77.5	178	22.3	1.6	105	139.5	19	4
3	90	190	23.9	1.6	127	152.5	19	4
4	116	229	23.9	1.6	157	190.5	19	8
5	142	254	23.9	1.6	186	218.0	22	8
6	167	279	25.4	1.6	216	241.5	22	8
8	218	343	28.6	1.6	270	298.5	22	8
10	270	406	30.2	1.6	324	362.0	25	12
12	320	483	31.8	1.6	381	432.0	25	12
14	358	533	35.0	1.6	413	476.5	29	12
16	409	597	36.8	1.6	470	539.5	29	16

ANSI 300型 FLANGES

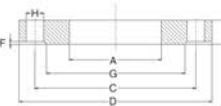

※尺寸	内径	※外径	厚	※厚度	※孔径	※中心	※孔径	※孔数
(B)	A	D	T	F	G	C	H	N
1+	50	156	20.7	1.6	73	114.5	19	4
2	61.5	165	22.3	1.6	92	127.0	22	8
2+	77.5	190	25.4	1.6	105	149.0	22	8
3	90	210	28.6	1.6	127	168.0	22	8
4	116	254	31.8	1.6	157	200	22	8
5	142	279	35.0	1.6	186	235	22	8
6	167	318	36.6	1.6	216	270	22	12
8	218	381	41.3	1.6	270	330	25	12
10	270	444	47.7	1.6	324	387.5	29	16
12	320	521	50.8	1.6	381	451	32	16
14	358	584	54.0	1.6	413	514.5	32	20
16	409	648	57.2	1.6	470	571.5	35	20



好品質 行天下

Sales Network
销售网络

THE GOOD QUALITY SELLS WORLD

共同发展是我们对客户的庄严承诺。多年来我们的产品和服务已经为合作伙伴们创造了巨大的经济效益。

今后，我们将继续坚持全心全意为客户服务的原则，不断优化和完善自我，向客户提供更优异的产品和服务。

我们真诚希望能够与新老客户携手共进，共创美好未来！

※ Joint develop,our promises to customers.we have bring considerable profits to our cooperators for many years on provide outstanding products and excellent service.

※ We will keep on in the future and bring more better products to all customers.

※ For wonderful cooperation and brilliant future,cheers!